

These instructions were originally for the Y-Cord or Harness Set, Ground Control cord part number 40107-1068, which has now been superseded by part number K10400-020 which is a J&M manufactured product. However these directions should work for installation of both harnesses.

February 1st, 1986
P/No. 99931-1191-01

Kawasaki | **Clarion**

AUDIO SYSTEM
OPTIONAL PARTS INSTALLATION GUIDE

HARNESS SET, GROUND CONTROL

English

Notice to Dealer:

This guide provides you with necessary information to install Kawasaki/Clarion Audio System optional parts on the motorcycle and should be read carefully and understood before starting the operation.

To know the Audio System operating procedures and cares, please refer to ZG1200 Audio System Operator's Manual (P/No. 99920-1345-01).

PARTS LIST

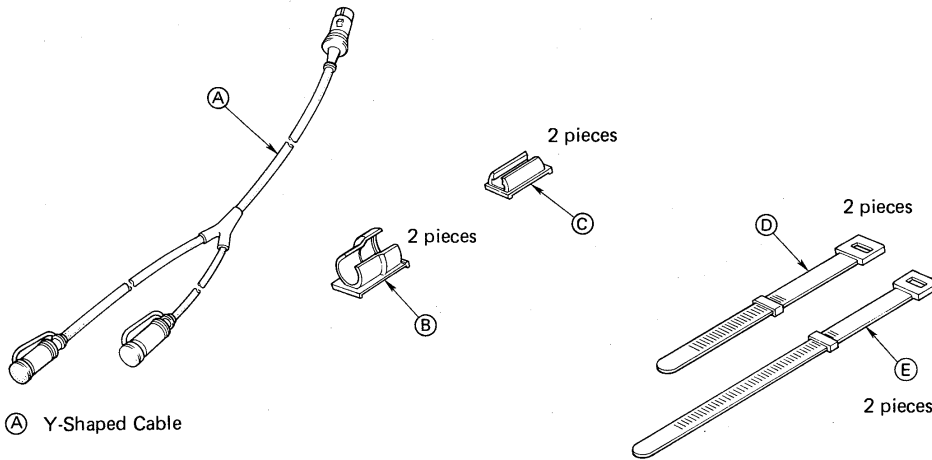

(A) Y-Shaped Cable

TOOLS REQUIRED

- 10 mm Socket
- Socket ratchet handle
- #1, #2 Phillips screwdriver
- 12 mm socket wrench
- 5.0 mm Allen wrench
- Pliers

- (B) Connector Holder
- (C) Holder
- (D) Strap
- (E) Strap

INSTALLATION PROCEDURE

Keep the ignition switch off during installation.

- Remove the Rearview Mirror, the Headlight Cover, the Headlight, the Windshield, the Low Cowl, the Side Cowl, the Rear Seat, the Driver's Seat and the Dummy Tank.
- Attach the Connector Holder (B) and the 2 Holders (C), and fix the Y-Shaped Cable (A) with the Holders (C) as shown in Fig. 1. Fix one end of the DIN Connector (female) to the Connector Holder (B), and connect the other end to the Main Unit DIN Cord as shown in the figure.
- Attach the Connector Holder (B) to the Rear Trunk as shown in Fig. 2. Place the Y-Shaped Cable (A) as shown, and fix its DIN Connector (male) to the Connector Holder (B) (fasten the cable at 4 points using the straps (D) and (E)).
- Replace the removed parts.

"NOTE"

- When connecting the fuel hoses to the fuel tank, make sure that the hose fastened with the thinner clip is connected to the fuel tap while the one with the thicker clip is connected to the check valve.
- When installing the lower fairing, make sure it is fitted tightly and leaves no gap.
- The metal fixture in the fairing right pocket should have no excessive play when the lid is attached to it.

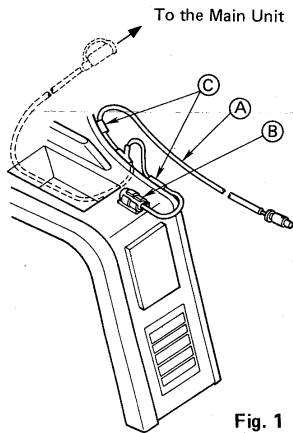

Fig. 1

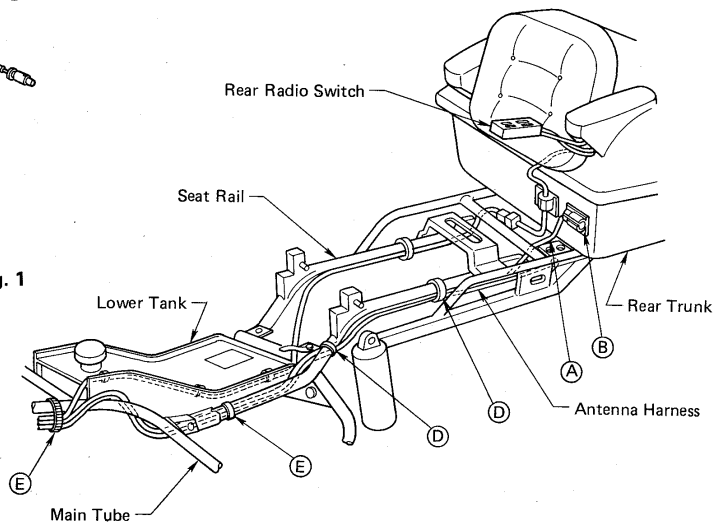

Fig. 2